

PIPE WORK PROTECTION TRIM
BACK BOX & BLANK PLATE WITH EARTH CABLE INSIDE AT LOW LEVEL.

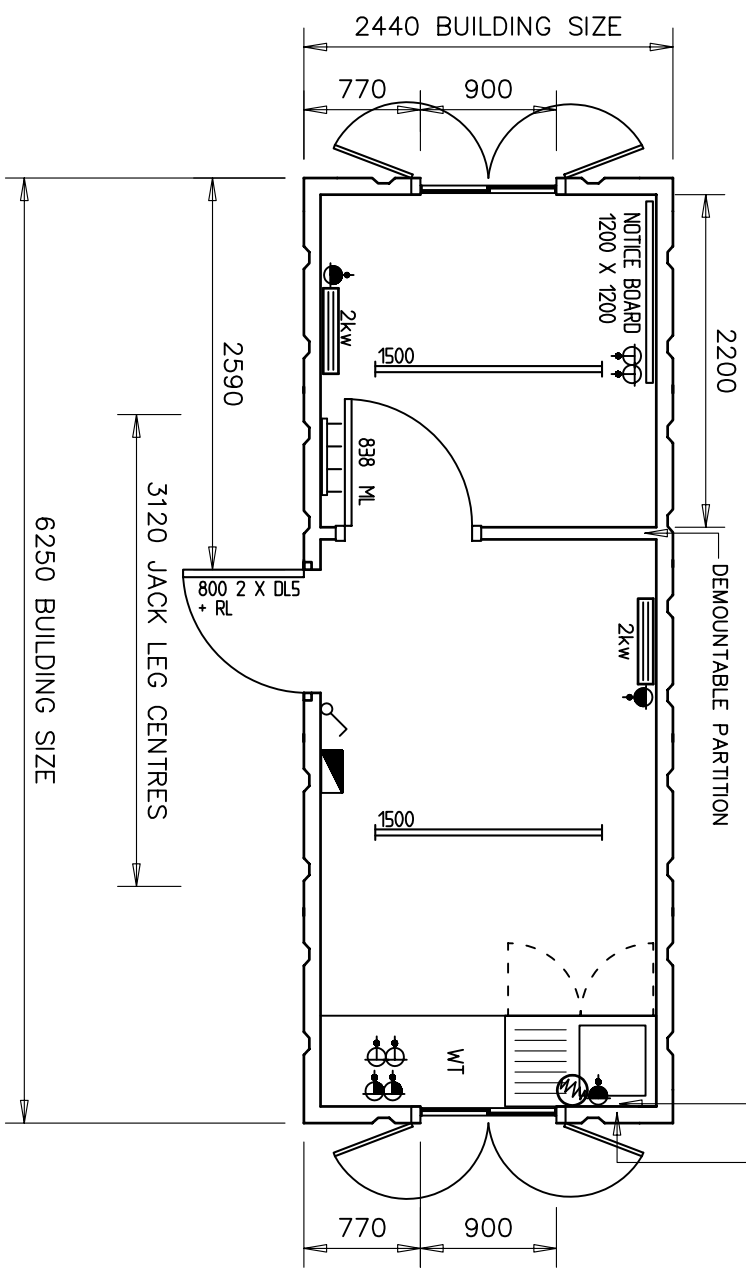

NOTES

1. COLOUR SPECIFICATION: BLUE (RAL 5013)
2. ALL LIGHTS CONTROLLED BY THE ONE LIGHT SWITCH.
3. 2NO. SIGN PLATES TO BE PLACED INSIDE UNIT
4. NO JACK LEGS REQUIRED

DRAWING STATUS	
<input checked="" type="checkbox"/>	1 PRELIMINARY FOR INFORMATION ONLY
<input type="checkbox"/>	2 ISSUED FOR APPROVAL
<input type="checkbox"/>	3 CLIENT APPROVED
<input type="checkbox"/>	4 ISSUED FOR CONSTRUCTION
<input type="checkbox"/>	5 AS BUILT
<input type="checkbox"/>	6

Project		20' X 8' STEEL OFFICE/CANTEEN UNIT	
Title		PLAN LAYOUT	
Date	01/09/05	Scale	1 : 50
Drawing No.	003000-S-114-1	Drawn By	K.S.L.
Rev.	-	Rev.	-
Product Code	-	Product Code	-
UNLADEN WEIGHT (KG)	2750	UNLADEN WEIGHT (KG)	2750
MAXIMUM LADEN WEIGHT (KG)	4900	MAXIMUM LADEN WEIGHT (KG)	4900
MAXIMUM LIFT WEIGHT (KG)	4900	MAXIMUM LIFT WEIGHT (KG)	4900
<ul style="list-style-type: none"> DISTRIBUTION BOARD CONVECTOR HEATER TUBULAR HEATER HIGH LEVEL FAN HEATER FLUORESCENT LIGHT BULKHEAD LIGHT WATER HEATER 13A TWIN SOCKET - LOW 13A TWIN SOCKET - HIGH WALL LIGHT SWITCH PULL LIGHT SWITCH THERMOSTAT EXTRACTION FAN COOKER POINT SHOWER HEATER COAT HOOKS SLIDING WINDOW COMPLETE WITH SHUTTER HL HIGH LEVEL TOV TOP OPENING VENT WT WORKTOP ML MORTICE LOCK BL BATHROOM LOCK DL5 S LEVER DEADLOCK RL ROLLER LATCH BB BARREL BOLTS 			